

CASE STUDY

KNOWSLEY HOUSING TRUST

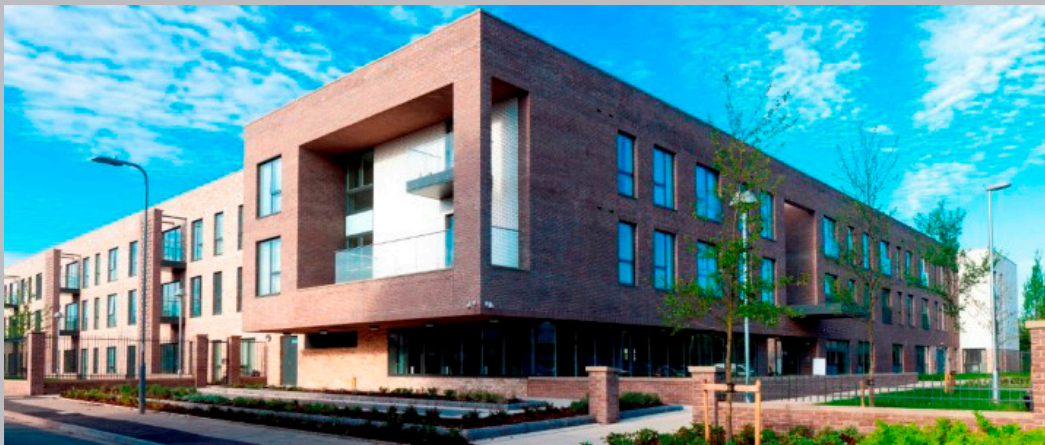

BLUEBELL PARK, ALAMEIN ROAD, HUYTON

This development of a 3-storey extra care complex, comprised 101nr 2-bedroom flats for rent including 7nr dedicated dementia flats. The complex also included a café, hairdressing salon and communal facilities.

As part of the complex, a separate 3-storey block of 21nr flats was also developed for sale.

The extra care building has achieved a BREEAM rating of 'Very Good' and includes a communal CHP heating system. A photo voltaic solar array is installed to the flats to provide electricity for communal areas.

Not only does this complex serve the resident's needs, but it also encourages closer integration with the local community through the introduction of public facilities such as the café and hairdressing salon.

PROJECT OVERVIEW

Client

Knowsley Housing Trust

Architect

PRP Architecture

Structural Engineer

Curtins Ltd

Building Services Engineer

PSD Ltd

Project Value

£12.4 million

Project Start/Completion

November 2012/March 2015

Appleyard & Trew's Role

Quantity Surveyor, Employer's Agent and CDM Adviser

Procurement

Design and Build



For further case studies please visit our website at:
www.appleyardandtrew.com

**appleyard
& trew**