



Appleyard & Trew were appointed by Manchester City Council as Quantity Surveyor and CDM Co-ordinator for the new Indoor BMX Centre and Associated Public Realm Works, situated adjacent to the Manchester Velodrome. The new building is approximately 14,350m² in area including a clear space area of 100m x 70m for the BMX track and associated spectator seating areas; ancillary areas for riders, officials and media. The building is joined with the Velodrome by a new link building including reception areas, administration areas, café and new office accommodation for British Cycling.

The Indoor BMX Centre project was funded by Manchester City Council, North West Development Agency and Sport England. The associated Public Realm Works were funded by the Homes and Communities Agency (HCA) and European Regional Development Fund (ERDF). Delivery of the project was by New East Manchester Ltd.

**Quantity Surveyor/
CDM Co-ordinator:**
Appleyard & Trew LLP

Architect:
Ellis Williams Architects

Value:
£19.5m (BMX)
£5m (Public Realm)

Procurement:
Design & Build;
NEC3 Form of Contract

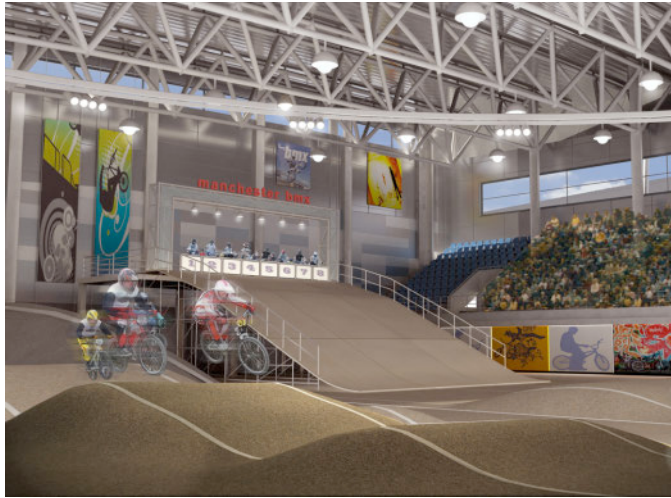

**PROJECT MANAGERS
BUILDING SURVEYORS
CDM CO-ORDINATORS
CHARTERED QUANTITY SURVEYORS**

